



■ 3.02



■ 3.04



■ 3.05



■ 3.06



■ 3.08



■ 3.10



■ 3.11



■ 3.12



■ 3.14



■ 3.17



■ 3.18



■ 3.17



■ 3.20



■ 3.22



■ 3.25



■ 3.26



■ 3.27



■ 3.29



■ 3.32



■ 3.33



■ 3.34

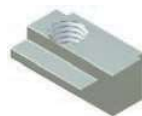

■ 3.34

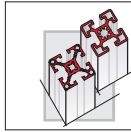

# GRUNDVERBINDER BASE CONNECTOR JONCTION DE BASE



**GV**

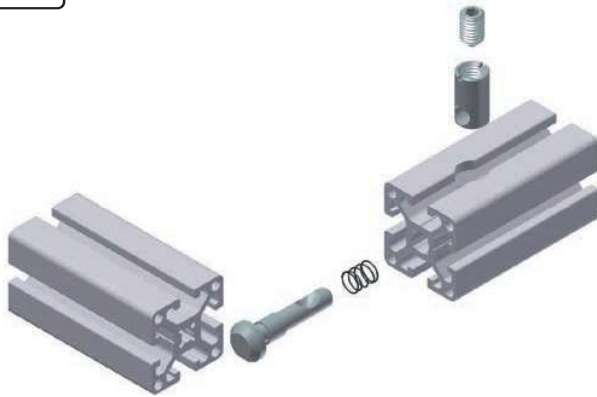

Bestehend aus:  
Hammerbolzen St, vz.  
Hülse St, vz.  
Feder  
Gewindestift

Consisting of:  
Hammerhead bolt St, galv.  
Sleeve St, galv.  
Spring  
Setscrew

Comprenant :  
Pièce d'ancrage Ac, zing.  
Barillet GV Ac, zing.  
Ressort  
Vis pointeau

### Innovative Vorteile

- Einfache und schnelle Montage
- Ringschneiden an Verbinderkopf (GV-0)
- Elektrisch leitfähige Verbindung
- Hohe Vielfalt der Verbinderfamilie
- Als Außen- und Innenverbindung einsetzbar

### Innovative advantages

- Easy and fast fitting
- Cutting edge on connector head (GV-0)
- Electrical conductive connector
- Highly versatile connector family
- Can be used as inner-fitting and outerfitting connector

### Atouts novateurs

- Montage rapide et simple
- Empreinte anti-glissement (GV-0)
- Assemblage conducteur
- Positionnement réglable et universel
- Etude simplifiée

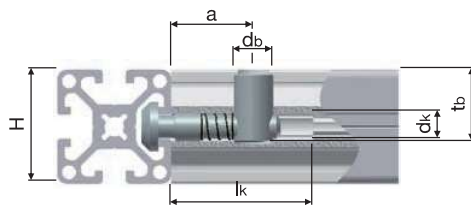
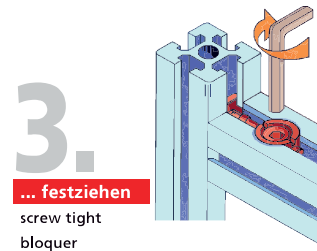
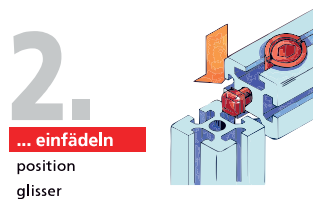
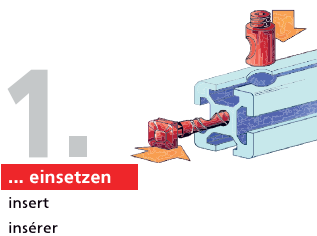

H	d <sub>s</sub>	d <sub>k</sub>	a	t <sub>s</sub>	l <sub>k</sub>
	Ø7.5	Ø5.0	15	14.3	30
	Ø10.5	Ø6.8	18	22	-
	Ø14.2	Ø10.2	29	20.5	-
	Ø14.2	Ø10.2	29	26	45
	Ø14.2	Ø10.2	29	26	-
	Ø16.2	Ø10.2	29	30	-
	Ø16.2	Ø10.2	29	32.5	-

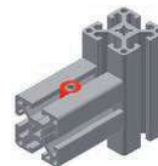

Innenliegende Verbindung  
Inner-fitting connector  
Positionnement interne



Außenliegende Verbindung  
Outer-fitting connector  
Positionnement externe

➔ ■ 14.01

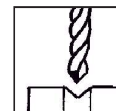

Technische Änderungen vorbehalten







# GRUNDVERBINDER BASE CONNECTOR JONCTION DE BASE



5 8E 8 10





**GV-0**



	15Nm	05.01590.00
	19Nm	05.02150.00
	26Nm	05.01596.00
	30Nm	05.01351.00
	35Nm	05.01352.00
	35Nm	05.01270.00





**GV-01**



	26Nm	05.01597.00
	33Nm	05.01110.00
	35Nm	05.01112.00
	35Nm	05.01271.00





**GV-02**



	26Nm	05.01598.00
	33Nm	05.01111.00
	35Nm	05.01113.00
	35Nm	05.01272.00





**GS-01**



	26Nm	05.02243.00
	12Nm	05.01353.00
	15Nm	05.01357.00
	13Nm	05.01357.50





**GS-02**



	10Nm	05.02244.00
	12Nm	05.01354.00
	15Nm	05.01358.00
	13Nm	05.01361.00





**GGV-01**



	10Nm	05.02245.00
	12Nm	05.01585.00
	15Nm	05.01553.00
	13Nm	05.01557.00





**GGV-02**



	10Nm	05.02246.00
	12Nm	05.01586.00
	15Nm	05.01554.00
	13Nm	05.01555.00





**GST**

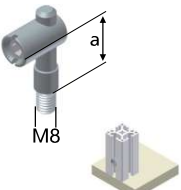

	26Nm	05.02247.00
	33Nm	05.01355.00
	35Nm	05.01359.00
	35Nm	05.01359.50



**GSR**



	26Nm	05.02248.00
	33Nm	05.01356.00
	35Nm	05.01360.00
	35Nm	05.01360.50

**GVP**

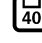

	26Nm	05.02249.00
	33Nm	05.01445.00
	35Nm	05.01556.00
	35Nm	05.01556.50

3

Technische Änderungen vorbehalten

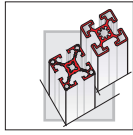

# AUTOMATIK-GV

## AUTOMATIC - BC (BASIC CONNECTOR)

### GV AUTOMATIQUE



#### AGV

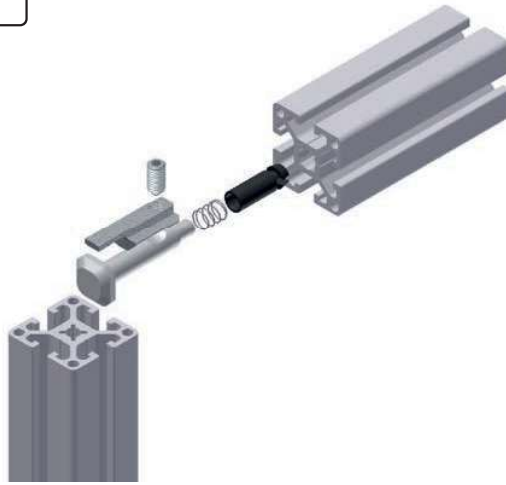

Bestehend aus:  
 AGV-Stein GD-Zn  
 Druckfeder PA  
 Federhülse PA  
 Hammerbolzen St, vz.  
 Gewindestift

Consisting of:  
 AGV block GD-Zn  
 Compression spring PA  
 Spring sleeve PA  
 Hammerhead bolts St, galv.  
 Setscrew

Comprenant :  
 Pièce d'ancrage AGV GD-Zn  
 Ressort PA  
 Manchon sur ressort PA  
 Coulisseau AGV Ac, zing.  
 Vis pointeau

#### Innovative Vorteile

- Sehr einfache und schnelle Montage
- Automatische Zentrierung
- Geringe Profilbearbeitung
- Verdrehgesichert durch Kopfform
- Ringschneide an Verbinderkopf
- Elektrische Leitfähigkeit
- Positionsgerechte, automatische Fügstellung

#### Innovative advantages

- Quick and easy to fit
- Automatic centring
- Minimum work on profile
- Head design prevents twisting
- Cutting edge on connector head
- Electrically conductive
- Automatic correct joint positioning

#### Atouts novateurs

- Montage très simple et rapide
- Autopositionnement de l'ancrage
- Usinage minime du profilé
- Anti-rotation du profilé
- Empreinte anti-glissement
- Assemblage conducteur
- Autocentrage



**1. ... einschieben**  
 push in  
 insérer



**2. ... platzieren**  
 position  
 positioner



**3. ... festziehen**  
 screw tight  
 bloquer

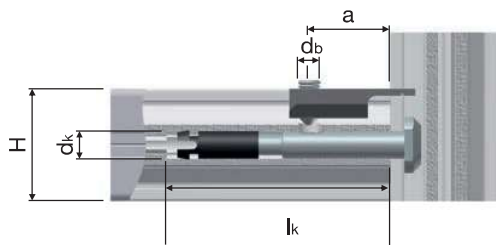

H	d <sub>b</sub>	d <sub>k</sub>	a	l <sub>k</sub>	Nm
30 8E	Ø5.4	Ø6.8	18	-	10
30 8K	Ø7.6	Ø10.2	30	-	15
40 8	Ø7.6	Ø10 *	30	80	15
40 8	Ø7.6	Ø10.2	30	-	15
45 10	Ø9.6	Ø10.2	30	-	25
50 10	Ø9.6	Ø10.2	30	-	25

30 8E	05.01780.00
ohne Federhülse	
30 8K	05.02242.00
ohne Federhülse	
40 8	05.01781.10
45 10	05.01782.10
50 10	05.01757.00

\* = Aufbohren des Kernlochs mit d<sub>k</sub>

\* = Drilling the core hole with d<sub>k</sub>

\* = Le forage du trou de base avec d<sub>k</sub>

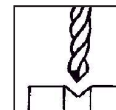

➔ ■ 14.01

# HÜLSENVERBINDER

## SLEEVE CONNECTORS

### FIXATION - HV



#### HV

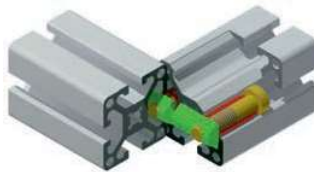

Bestehend aus:  
 Hülse, SF St, vz.  
 ISO-Schraube St, vz.  
 Nutenstein St, vz.

Consisting of:  
 Sleeve, SF St, galv.  
 ISO screw St, galv.  
 Sliding block St, galv.

#### HV-Stoßverbinder

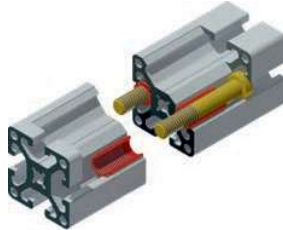

Comprenant:  
 Douilles-insert Ac, zing.  
 Vis ISO Ac, zing.  
 Coulisseau Ac, zing.



#### Innovative Vorteile

- Hülse selbstzentrierend durch langen Zentrierschaft
- Keine Profilbearbeitung
- Leichtes Eindrehen der Hülse durch Selbstfurchende Gewindeform "FM-Spezial" und Gleit-Mo-Beschichtung
- Hohe Verbindungsfestigkeit
- Stabile, verdrehgesicherte Verbindung
- Elektrische Leitfähigkeit

#### Innovative advantages

- Sleeve self-centring with long centring shaft
- No work on profiles
- Self-tapping thread "FM-Spezial" and Gleit-Mo coating make it easier to screw in sleeves
- High connecting strength
- Sturdy, non-twisting connection
- Electrically conductive

#### Atouts novateurs

- Insert auto-centreur
- Aucun usinage du profilé
- Vissage facile par insert autotaraudeur "FM-Spezial" et enduction GleitMo
- Stabilité impeccable
- Antirotation du profilé
- Assemblage conducteur

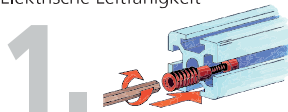

**1. ... einschrauben**  
 screw in  
 visser



**2. ... einfädeln**  
 position  
 insérer

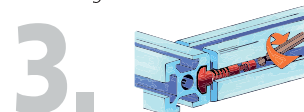

**3. ... festziehen**  
 screw tight  
 bloquer

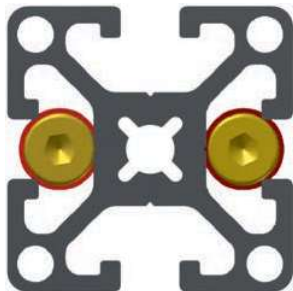

Hülsenverbinder müssen grundsätzlich **PAARWEISE** eingesetzt werden.

Sleeve connectors must be used in **PAIRS**

Utilisation impérative par **PAIRE**

#### HV

15 Nm				05.02173.10
19 Nm				05.02127.10
22 Nm				05.02128.10 *
25 Nm				05.02129.10 *
25 Nm				05.02129.00

#### HV-Stoßverbinder

12 Nm				05.02439.00
20 Nm				05.02440.00 *
25 Nm				05.02441.00 *
				* wird benötigt Sternschlüssel-Bit SX-50 05.02126.00

Technische Änderungen vorbehalten

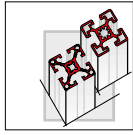

# BOLZENVERBINDER BOLT CONNECTOR JONCTION A BOULONS



**BV**

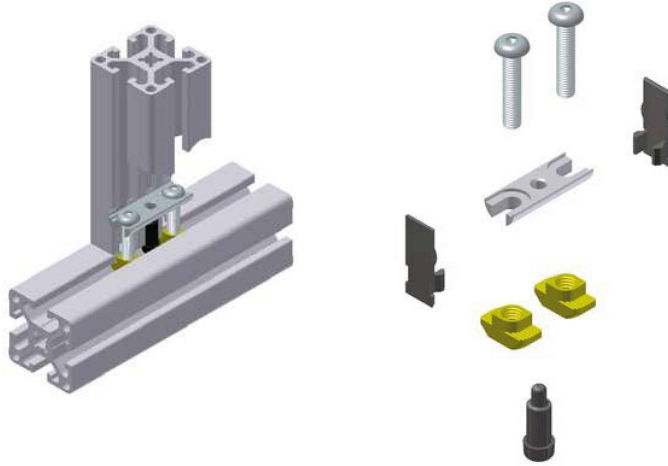

Bestehend aus:  
Bolzen St, vz.  
ISO-Schrauben  
Hammermütern PA  
Fixierbolzen  
Abdeckkappen

Consisting of:  
Bolts St, galv.  
ISO screws  
Hammer nuts PA  
Fastening bolts  
Caps

Comprenant :  
Ancrage demi-lune Ac, zing.  
Vis ISO  
Ecrou de rainure  
Centreur PA  
Capuchon

### Innovative Vorteile

- Sehr hohe Verbindungs- und Verdrehfestigkeit
- Selbstzentrierend durch Zentrierzapfen
- Beidseitig gleichmäßiger Anzug über Hammermütern
- Leitfähige Verbindung durch Riefen an der Hammermutter

### Innovative advantages

- High connecting strength and twist resistance
- Centring pin for self-centring
- Even tightening on both sides with hammer nuts
- Ribbing on hammer nuts for conductive connection

### Atouts novateurs

- Stabilité et blocage impeccables
- Autocentrage par pion axial
- Serrage bilatéral uniforme par vis et écrou de rainure
- Assemblage conducteur

1.

... einschieben

push in  
insérer

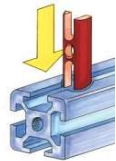

2.

... sichern

secure  
sécuriser

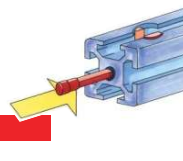

3.

... festziehen

tighten  
bloquer

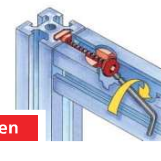

### Ausführung

- A** Stahl, verzinkt  
Zugfestigkeit ca. 550N/mm<sup>2</sup>
- B** Zinkdruckguss  
Zugfestigkeit ca. 300N/mm<sup>2</sup>

### Design

- A** Galvanized steel  
tensile strength 550N/mm<sup>2</sup>
- B** Zinc diecast  
tensile strength 300N/mm<sup>2</sup>

### Matières

- A** Acier zingué  
Résistance 550N/mm<sup>2</sup>
- B** Zamak  
Résistance 300N/mm<sup>2</sup>

H	d <sub>n</sub>	a	Nm
30	Ø11.2	18	6
30 <sup>lock</sup>	Ø11.2	18	6
40	Ø14.2	20	22
45	Ø17.2	22,5	25
50	Ø17.2	22,5	25

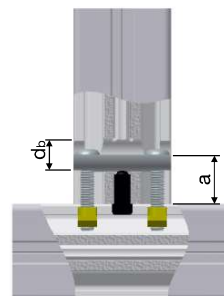

➔ ■ 14.01



Technische Änderungen vorbehalten

**BOLZENVERBINDER**  
**BOLT CONNECTOR**  
**JONCTION A BOULONS**



8E 8 10

**BV Ø11 L=30**

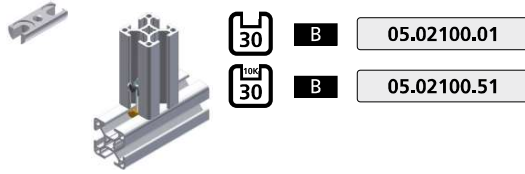

**BV Ø11 L=60**

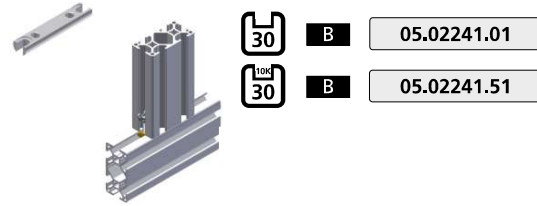

**BV Ø14 L=40**

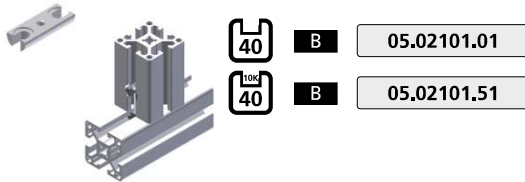

**BV Ø14 L=80**

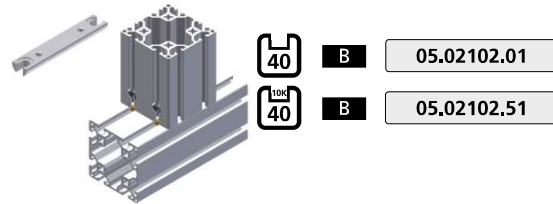

**BV Ø17 L=45**

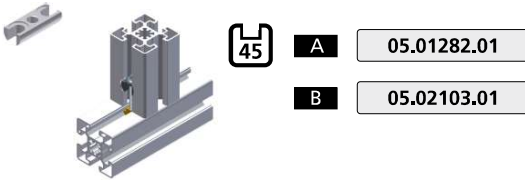

**BV Ø17 L=60**

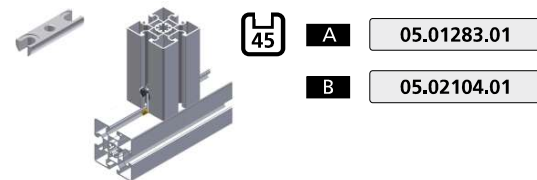

**BV Ø17 L=90**

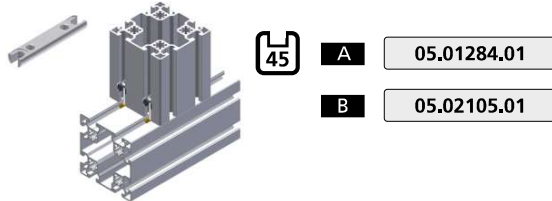

Artikel auf dieser Seite:  
 PE (St.) = 10

**BV Ø17 L=50**

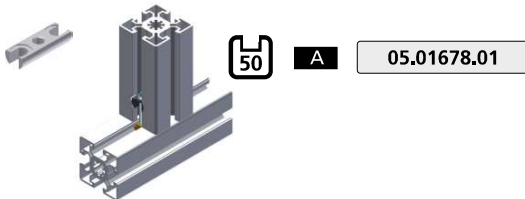

**BV Ø17 L=100**

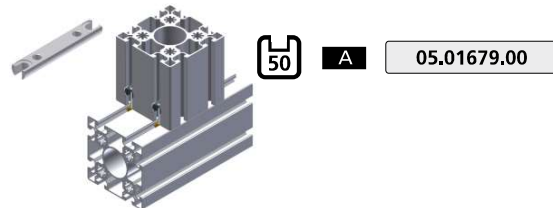

3

Technische Änderungen vorbehalten

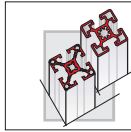

# PLATTENVERBINDER PLATE CONNECTOR FIXATION PV



**PV**

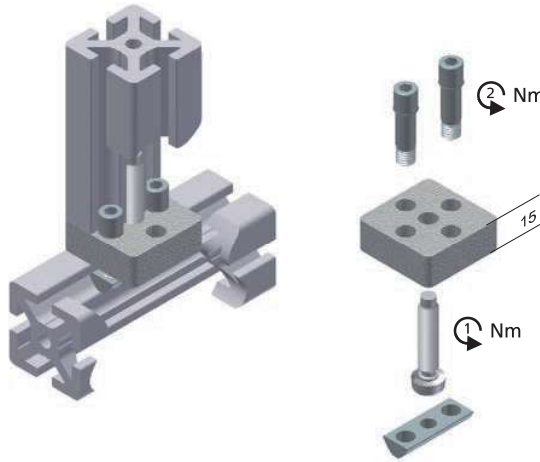

Bestehend aus:  
**Platte** GD-Zn  
**Passschraube** St, vz.  
**FM-Schraube**  
**Nutenstein**

Consisting of:  
**Plate** GD-Zn  
**Set screw** St, galv.  
**FM screw**  
**Sliding block**

Comprenant :  
**Platine** GD-Zn  
**Vis épaulée** Ac, zing.  
**Vis FM autotaraudeuse**  
**Barrette écrou**

### Innovative Vorteile

- Einfaches Verbinden ohne Profilbearbeitung
- Leichtes Eindrehen durch selbst-furchende Verbinderschraube mit "FM-Spezial"-Gewinde
- Exakte und automatische Zentrierung
- Schnelle Montage durch vormontierte Einheit
- Leitfähige Verbindung

### Innovative advantages

- Easy connection without work on profile
- Self-tapping connector screw with "FM-Spezial"-thread for easy screwing in
- Exact and automatic centring
- Pre-assembled unit for quick fitting
- Conductive connection

### Atouts novateurs

- Fixation aisée - aucune opération d'usinage
- Vissage facile par vis autotaraudeuse
- Autocentrage automatique
- Assemblage conducteur
- Compatibilité avec tous profilés et rainures existants

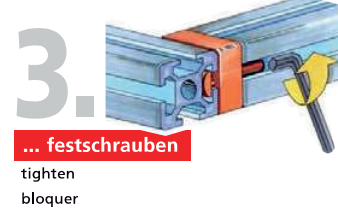
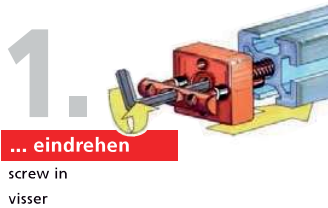

### Ausführung

- A** Zinkdruckguss  
Zugfestigkeit ca. 300N/mm<sup>2</sup>
- B** RAL 9006

### Design

- A** Zinc diecast  
tensile strength 300N/mm<sup>2</sup>
- B** RAL 9006

### Matières

- A** Zamak  
Résistance ca. 300N/mm<sup>2</sup>
- B** RAL 9006

H	1 Nm	2 Nm
40	25	22
45	35	26
50	35	26

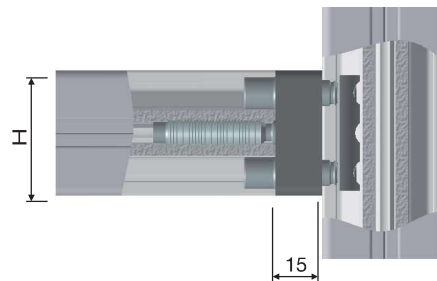

Technische Änderungen vorbehalten



# PLATTENVERBINDER PLATE CONNECTOR FIXATION PV



## 40x40



- A** 05.01760.00
- B** 05.01760.20
- 05.01761.00

Eine Nut offen  
· One groove open  
· Une rainure ouverte

## 40x80

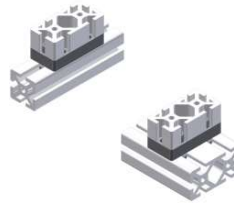

- A** 05.01762.00
- B** 05.01762.20
- A** 05.01762.02
- B** 05.01762.22

## 40x120

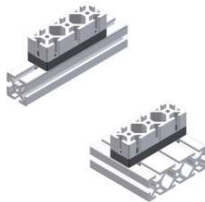

- A** 05.01689.00
- B** 05.01689.20
- A** 05.01689.02
- B** 05.01689.22

## 80x80

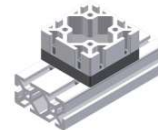

- A** 05.01764.00
- B** 05.01764.20

## 45x45



- A** 05.01766.00

## 45x60

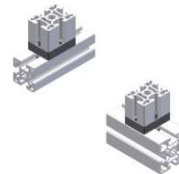

- A** 05.01699.00
- B** 05.01699.20
- A** 05.01768.00

## 45x90

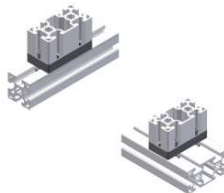

- A** 05.01769.00
- B** 05.01769.20
- A** 05.01769.02
- B** 05.01769.22

## 60x60

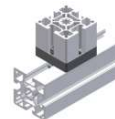

- A** 05.01770.00

## 90x90

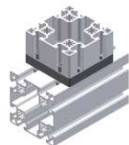

- A** 05.01772.00

## 50x50

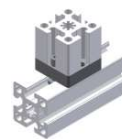

- A** 05.01680.00

## 50x100

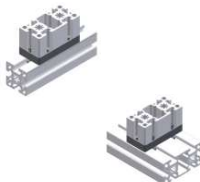

- A** 05.01682.00
- A** 05.01682.02

## 100x100

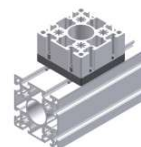

- A** 05.01683.00



Technische Änderungen vorbehalten

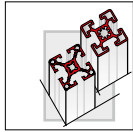

# END-VERBINDER END CONNECTOR NOIX TERMINALE - END



## END

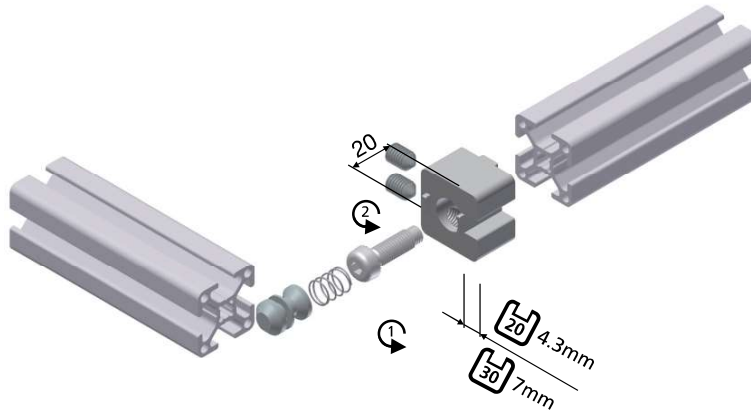

<b>Bestehend aus:</b>	
Grundkörper	GD-Zn
FM-Schraube	St, vz.
Feder	
Gewindestift	
Bolzen	
<b>Consisting of:</b>	
Basic unit	GD-Zn
FM screw	St, galv.
Spring	
Set screw	
Bolts	
<b>Comprenant :</b>	
Noix	GD-Zn
Vis FM autotaraudeuse	
Ressort	Ac, zing.
Pion de guidage	
Vis pointeau	

### Innovative Vorteile

- Einfaches verbinden
- Ohne Profilbearbeitung
- Leichtes eindrehen durch selbstfurchende Schraube
- Aufnahme von Flächenelementen

### Innovative advantages

- Easy to connect
- Without work on profile
- Easy to screw in self-tapping connecting screw
- Attachment of panel elements

### Atouts novateurs

- Fixation aisée
- Aucun usinage
- Vissage facile par vis autotaraudeuse
- Adaptation de panneaux de remplissage

### Ausführung

- A** GD-Zn, natur
- B** GD-Zn, RAL 9006

### Design

- A** Zinc diecast (GD-Zn), natural
- B** Zinc diecast (GD-Zn), RAL 9006

### Matières

- A** Zamak, nature
- B** Zamak, RAL 9006

Technische Änderungen vorbehalten

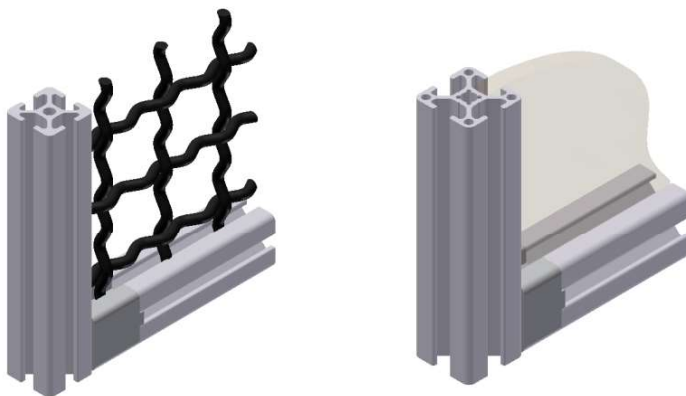

		<b>A</b>	<b>05.01640.00</b>
		<b>B</b>	<b>05.01642.00</b>
			15 Nm
			15 Nm
		<b>A</b>	<b>05.01641.00</b>
		<b>B</b>	<b>05.01643.00</b>
			25 Nm
			18 Nm

# UNI-VERBINDER UNI CONNECTOR FIXATION UNI



**UNI**

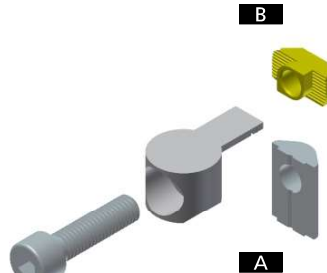
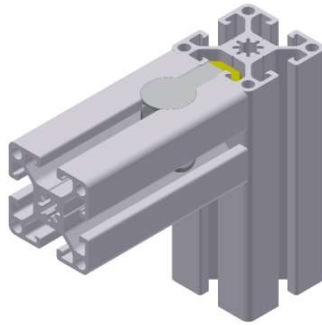

Bestehend aus:  
UNI-Verbinderstück GD-Zn  
ISO-Schraube St, vz.  
Hammermutter oder  
Nutenstein

Consisting of:  
UNI connector GD-Zn  
ISO screw St, galv.  
Hammer nuts or  
Sliding block

Comprenant :  
Barillet UNI GD-Zn  
Vis ISO Ac, zing.  
Ecrou de rainure ou  
Barrette écrou



### Innovative Vorteile

- Für alle Profilmuten einsetzbar
- Nachträglicher Einbau
- Verdrehgesicherte Verbindung
- Leitfähige Verbindung durch Riefen an der Hammermutter
- Universell einsetzbar, da kombinierbar mit allen Nuten

### Innovative advantages

- Suitable for all profile slots
- Retrofittable
- Non-twisting connector
- Ribbing on hammer nut for conductive connection
- Combinable with all slots for universal application

### Atouts novateurs

- Positionnement réglable et universel
- Insérable dans une structure sans redémontage
- Anti-rotation du profilé
- Assemblage conducteur
- Compatibilité avec tous profilés et rainures existants

Verbinder sollten **PAARWEISE** eingesetzt werden

Connectors should be used in **PAIRS**

Résistance optimale par **PAIRE**

1.

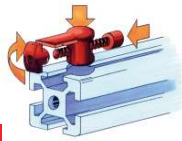

**... einschieben**  
push in  
insérer

2.

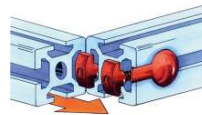

**... einfädeln**  
position  
glisser

3.

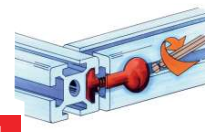

**... festziehen**  
tighten  
bloquer



H	Db	db	a	tb	Nm
20 5	Ø12	Ø4.3	10	8.5	5
30 8E	Ø16	Ø5.5	15	12.7	15
40 8	Ø20	Ø7	20	16	25
45 10	Ø20	Ø7	20	16	30
50 10	Ø20	Ø7	20	16	30

20 5 A 05.01608.00

30 8E A 05.01609.00

B 05.01609.50

40 8 A 05.01610.00

B 05.01610.50

45 10 A 05.01644.00

50 10 B 05.01644.50

➔ ■ 14.01



Technische Änderungen vorbehalten

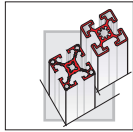

# WÜRFELVERBINDER CUBE CONNECTOR RACCORD DE CUBE



- Für verdrehgesicherte Eckverbindungen
  - Keine Endenbearbeitung
  - Leichtes Eindrehen durch selbstfurchende Verbinderschraube mit "FM-Spezial"-Gewinde
- For non-twisting corner connection
  - No work on profile
  - Self-tapping screw with "FM-Spezial"- thread for easy screwing in
- Pour jonction antirotation d'angle
  - Aucun usinage de profile
  - Vissage facile pour vis autotaradeuse



**20-90°/2**

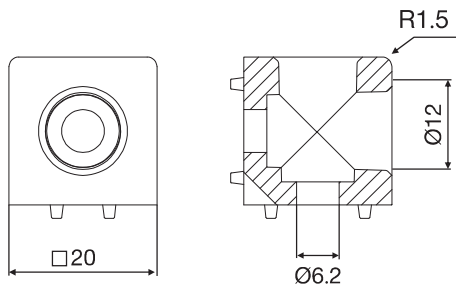

		GD-AI	RAL 9006
	+		
		05.02276.00	05.02276.20
	+		
		05.02276.05	05.02276.25

**20-90°/3**

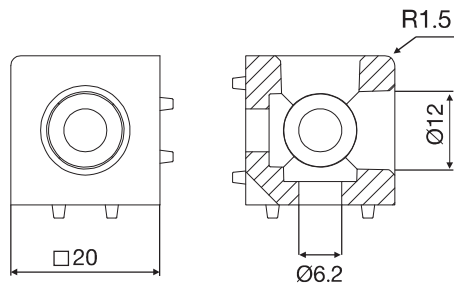

		GD-AI	RAL 9006
	+		
		05.02277.00	05.02277.20
	+		
		05.02277.05	05.02277.25

**30-90°/2**

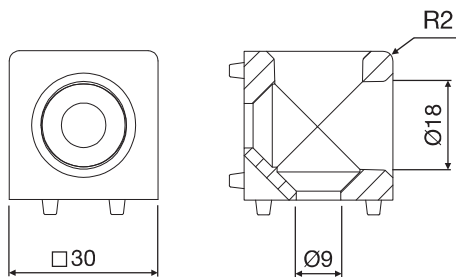

		GD-AI	RAL 9006
	+		
		05.02203.00	05.02203.20
	+		
		05.02203.05	05.02203.25

**30-90°/3**

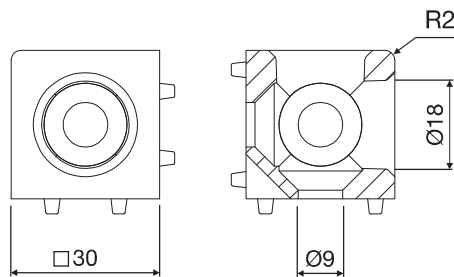

		GD-AI	RAL 9006
	+		
		05.02204.00	05.02204.20
	+		
		05.02204.05	05.02204.25

Technische Änderungen vorbehalten

# WÜRFELVERBINDER

## CUBE CONNECTOR

### RACCORD DE CUBE



**40-90°/2** 8

GD-AI RAL 9006

+	05.02205.00	05.02205.20
+  +	05.02205.05	05.02205.25

**40-90°/3** 8

GD-AI RAL 9006

+	05.02206.00	05.02206.20
+  +	05.02206.05	05.02206.25

**45-90°/2** 10

GD-AI RAL 9006

+	05.02209.00	05.02209.20
+  +	05.02209.05	05.02209.25

**45-90°/3** 10

GD-AI RAL 9006

+	05.02210.00	05.02210.20
+  +	05.02210.05	05.02210.25

**50-90°/3** 10

GD-AI

+  +	05.02212.05
------	-------------



Technische Änderungen vorbehalten

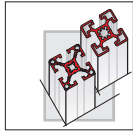

# ECKWINKEL 20, 30, 40, 45

3-WAY CONNECTION ANGLE 20, 30, 40, 45

CORNIERE D'ANGLE 20, 30, 40, 45



**A** GD-Zn

PA6

M 5x16  
SF 8x40  
SF 12x40

**B** GD-Zn

PA6

M 5x16  
SF 8x40  
SF 12x40

**C** GD-Zn

PA6

SF 8x40  
SF 12x40

**20**

**30**

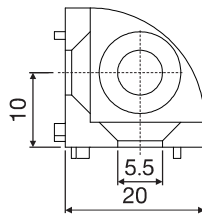
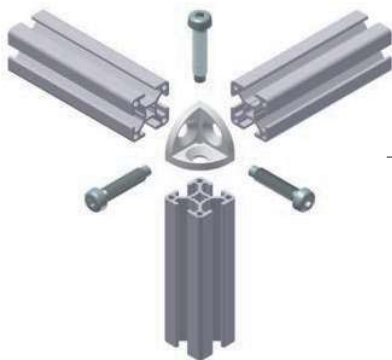

**5** **A** 05.02080.00

**5** **B** 05.02080.10

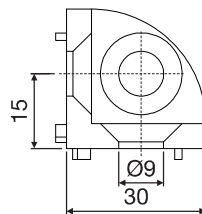

**8E** **A** 05.02146.00

**8E** **B** 05.02146.10

**40**

**45**

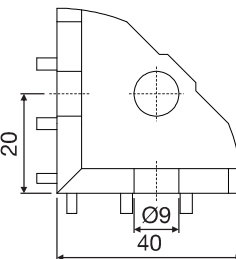
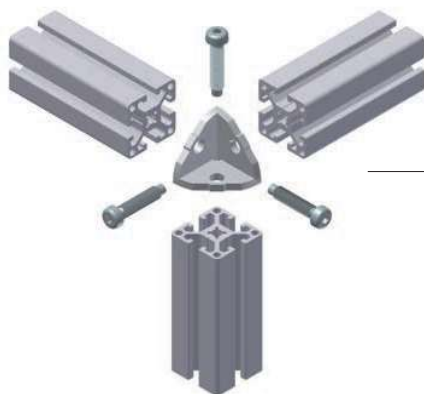

**8** **A** 05.02147.00

**8** **B** 05.02147.10

**8** **C** 05.02147.20

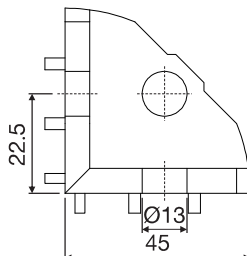

**10** **A** 05.02124.00

**10** **B** 05.02124.10

Technische Änderungen vorbehalten

**INNENWINKEL**  
INTERNAL ANGLE  
ANGLE INTÉRIEUR



Typ **A**

Typ **M**

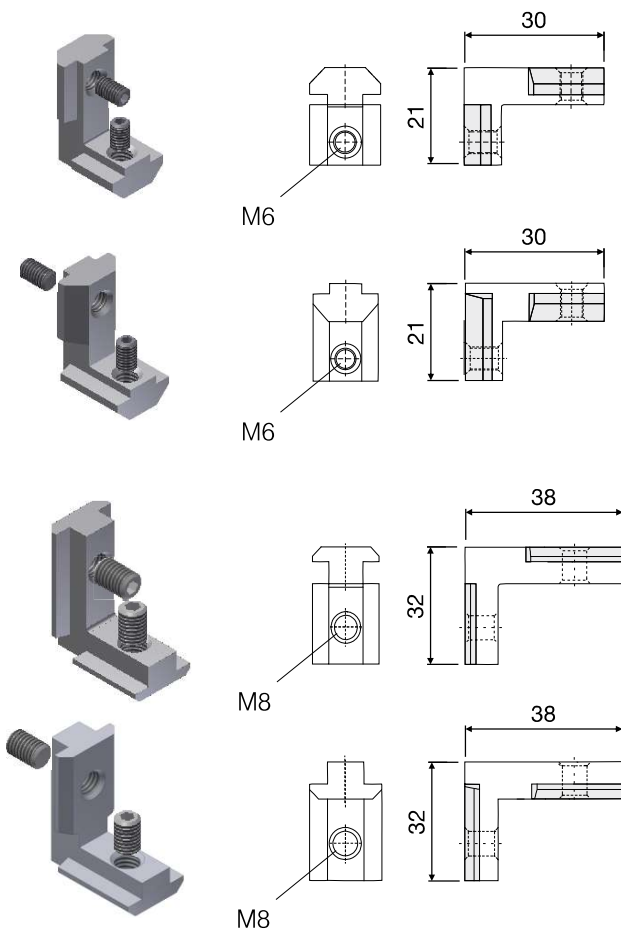
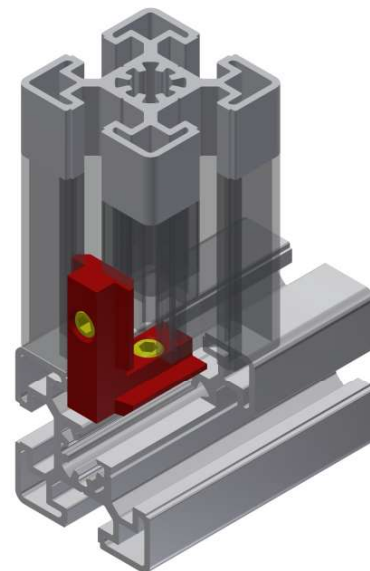
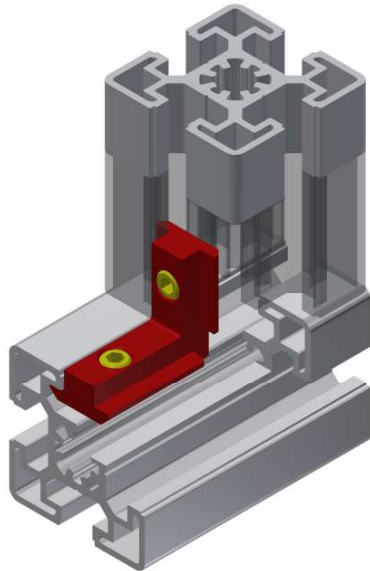

**A** 40 8 05.02389.00

**M** 40 8 05.02388.00

**A** 45 10 05.02391.00

**M** 45 10 05.02390.00

Technische Änderungen vorbehalten

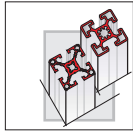

**FM-SCHRAUBEN**  
**FM-SCREW**  
**VIS FM**



**Innovative Vorteile**

- Kein Gewinde schneiden
- Selbstfurchende Gewindeform
- Hohe Verbindungsfestigkeit
- Perfektes Handling durch tiefen Innensechskant
- Hohe Sicherung durch starke Sperrverzahnung am Schraubenkopf
- Elektrisch leitfähig

**Innovative advantages**

- No thread cutting
- Self-tapping thread form
- High connecting strength
- Deep hexagon socket for perfect handling
- Strong lock toothing on screw head for high safety
- Electrically conductive

**Atouts novateurs**

- Taraudage superflu
- Vissage facile autotaraudeur
- Blocage impeccable
- Serrage optimum - profondeur accentuée du six pans creux
- Blocage grip sous la tête de vis
- Assemblage conducteur

**SF 5x16**

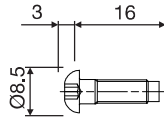

Anwendung

**END**

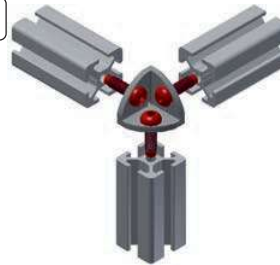

15 Nm  
 Festigkeitsklasse 8.8  
 Strength class 8.8  
 Classification de résistance 8.8

**05.01126.00**

**Senkschb. SF 7,1x30**

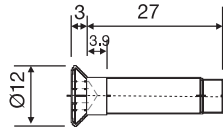

Anwendung

**Gelenk**

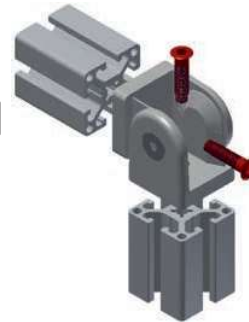

25 Nm  
 Festigkeitsklasse 8.8  
 Strength class 8.8  
 Classification de résistance 8.8

**05.01538.00**

**Flachkopfschb. SF 7,4x30**

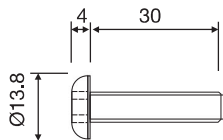

Anwendung

**VSI**

**PV**

**Gelenk**

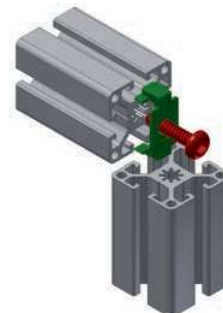

25 Nm  
 Festigkeitsklasse 8.8  
 Strength class 8.8  
 Classification de résistance 8.8

**05.01125.50**

Technische Änderungen vorbehalten



# FM-SCHRAUBEN

FM-SCREW

VIS FM



## SF 8x25

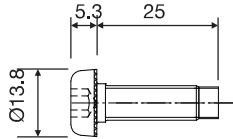

Anwendung

- VSI
- PV
- Gelenk

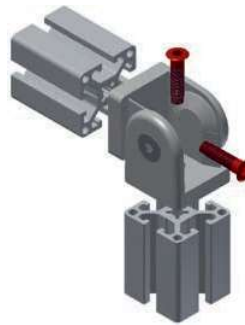

SW5  
25 Nm  
Festigkeitsklasse 8.8  
Strength class 8.8  
Classification de résistance 8.8

05.01124.00



## SF 8x40

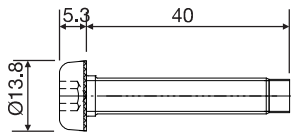

Anwendung

- VSA

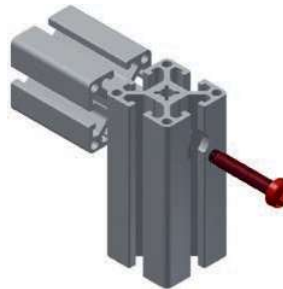

SW5  
25 Nm  
Festigkeitsklasse 8.8  
Strength class 8.8  
Classification de résistance 8.8

05.01125.00

## SF 12x40

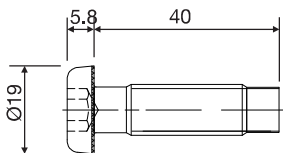

Anwendung

- PV
- VSI



SW8  
35 Nm  
Festigkeitsklasse 8.8  
Strength class 8.8  
Classification de résistance 8.8

05.01127.00

## M12x30\*

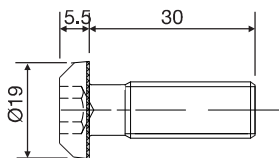

Anwendung

- VSI

\*M12

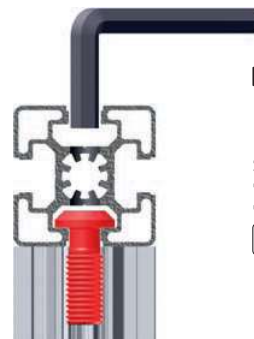

SW8  
40 Nm  
Festigkeitsklasse 8.8  
Strength class 8.8  
Classification de résistance 8.8

05.01083.00

Technische Änderungen vorbehalten

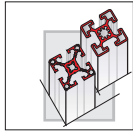

# GEHRUNGSVERBINDER

## MITRE CONNECTOR

### JOINT A ONGLET

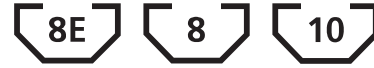

#### Innovative Vorteile

- Gehrungsverbindung von Profilen, die unter 30° bzw. 45° gesägt sind
- Vibrationsfreie Verbindung durch Spezialschrauben

#### Innovative advantages

- Mitre connector of profiles that are sawn below 30° or 45°
- Special screws for non-vibrating connection

#### Atouts novateurs

- Assemblages coupés d'onglet à 30° et 45°
- Aucun usinage

#### Ausführung

Stahlblech, verzinkt

#### Design

Sheet steel, galv.

#### Version

Plaque d'acier zinguée

Anwendungsbeispiele  
Applications • Applications



**GEV-8** 8E  
8

6 Nm

05.01290.00

**GEV-10** 10E

10 Nm

05.01291.00

**GEV-8-45°** 8E  
8

6 Nm

05.01253.00

**GEV-10-45°** 10E

10 Nm

05.01254.00

Technische Änderungen vorbehalten

**NOTIZEN**  
NOTES  
NOTATION

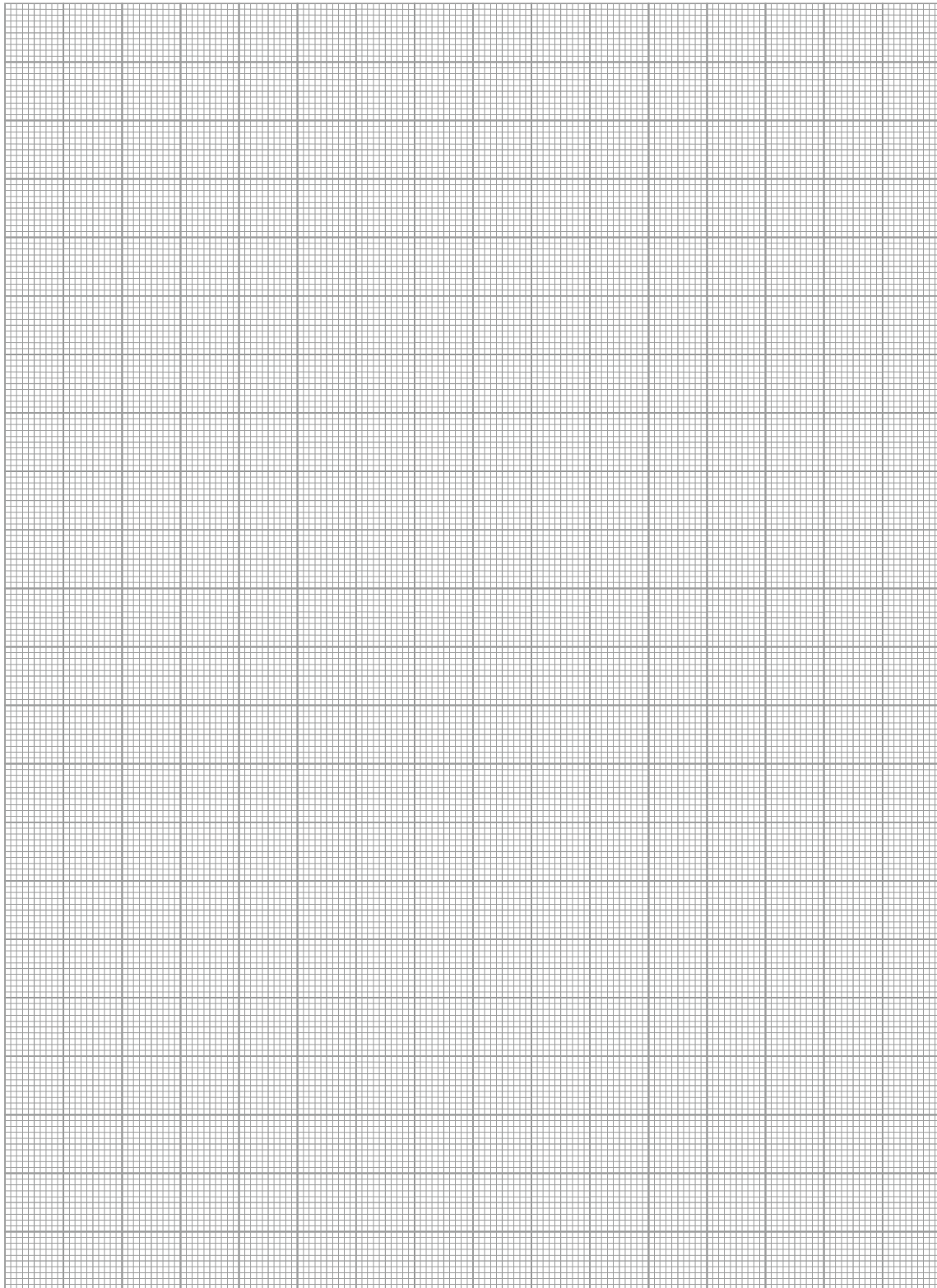

Technische Änderungen vorbehalten

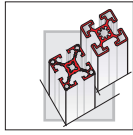



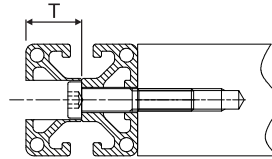
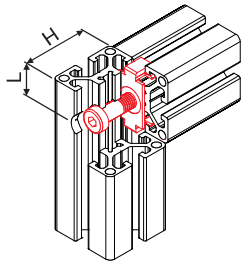

**VERBINDERSCHRAUBE AUSSEN**  
**CONNECTOR SCREW EXTERNAL**  
**VIS DE JONCTION EXTERIEUR**

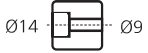
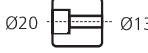

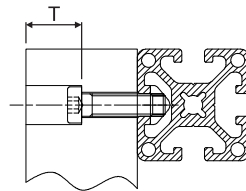
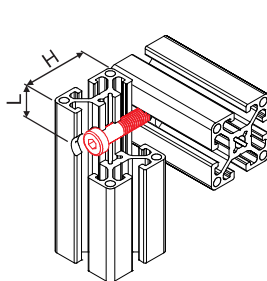
Verdrehsicherung  
 Anti-torsion element  
 Securite anti-torsion

		H	T	L		DIN 7984	
<b>VSA 10</b> 	<b>5</b>	20x20	6.5	10	M5 x 25	05.01497.00	05.02279.00
		40x40	6.5	10	M5 x 50	05.01618.00	05.01560.00
<b>VSA 14</b> 	<b>8E</b>	30x30	10	15	M8 x 40	05.01505.00	05.01137.00
	<b>8</b>	40x40	12.5	20	M8 x 50	05.01620.00	05.01561.00
		80x80	52.5	20	M8 x 50	05.01620.00	05.01561.00
<b>VSA 20</b> 	<b>10</b>	45x45	13.5	22.5	M12 x 60	05.01508.00	ISO 4762 05.01562.00
		60x60	13.5	30	M12 x 80	05.01619.00	ISO 4762
		90x90	58.5	22.5	M12 x 110	05.01509.00	ISO 4762 05.01368.00



		H	T	L		DIN 7984		
<b>VSA 10</b> 	<b>5</b>	20x20	6.5	10	M5 x 20	05.01496.00	05.01656.00	
		40x40	6.5	10	M5 x 40	05.01392.00	05.01656.00	
<b>VSA 14</b> 	<b>8E</b>	30x30	10	15	M8 x 25	05.01503.00	05.01870.00	
	<b>8</b>	40x40	12.5	20	M8 x 40	05.01504.00	05.01652.00	
		80x80	52.5	20	M8 x 40	05.01504.00	05.01652.00	
<b>VSA 14</b> 	<b>10</b>	45x45	13.5	22.5	M8 x 30	05.01504.00	05.01064.00	05.01107.00
		60x60	13.5	30	M8 x 55	05.01649.00	05.01064.00	05.01107.00
		90x90	58.5	22.5	M8 x 40	05.01505.00	05.01064.00	05.01107.00

Technische Änderungen vorbehalten

# VERBINDERSCHRAUBE INNEN CONNECTOR SCREW INTERNAL VIS DE JONCTION INTERIEUR

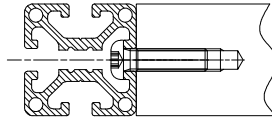
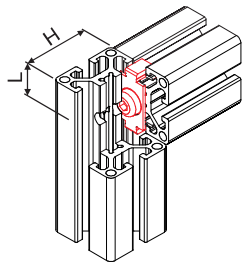

Verdrehsicherung  
Anti-torsion element  
Securite anti-torsion



Gd-Zn



St. verz.



FM-Schraube



ISO 7380



Profile	Size	Material	Dimensions	Accessories	Price	Thread	Price
VSI Ø4.3	5	A	20x20	SF 5 x 16	05.01362.00	M5 x 16	05.01365.00
		B	20x20	SF 5 x 16	05.02201.10	M5 x 16	05.02201.20
VSI Ø7	8E		30x30			M8 x 25	05.01136.00
	8	A	40x40	* SF 8 x 25	05.01363.00	M8 x 25	05.01366.00
B		40x40	* SF 8 x 25	05.02202.10	M8 x 25	05.02202.20	
VSI Ø9.5	10		45x45	SF 12 x 40	05.01364.00	M12 x 30	05.01367.00
			90x90	SF 12 x 40	05.01364.00	M12 x 30	05.01367.00

\* Nicht für 40x40EL, 40x80EL, 80x80EL geeignet

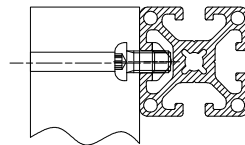
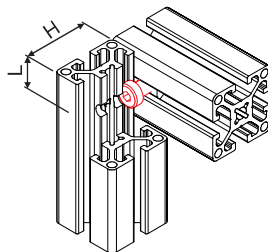

Profile	Size	H	L	Accessories	Price	Price	Price
VSI Ø4.3	5	20x20	10	M5 x 8	05.01400.00	05.01656.00	
		40x40	10	M5 x 8	05.01400.00	05.01656.00	
VSI Ø7	8E	30x30	15	M8 x 12	05.01419.00	05.01870.00	
	8	40x40	20	M8 x 16	05.01412.00	05.01652.00	
		80x80	20	M8 x 16	05.01412.00	05.01652.00	
VSI Ø9.5	10	45x45	22.5	M8 x 16	05.01412.00	05.01064.00	05.01107.00
		60x60	30	M8 x 16	05.01412.00	05.01064.00	05.01107.00
		90x90	22.5	M8 x 16	05.01412.00	05.01064.00	05.01107.00

Technische Änderungen vorbehalten

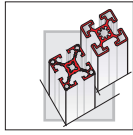

# ISO-SCHRAUBEN

## ISO-SCREWS

### VIS-ISO

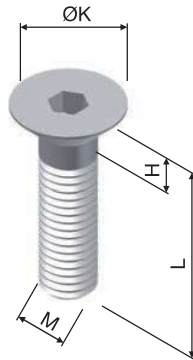

SW3 - M5  
SW4 - M6  
SW5 - M8

St, vz. - Festigkeitsklasse 8.8  
Steel, galvanized - Strength class 8.8  
Acier, galvanisé - Classification de résistance 8.8

#### ISO 10642 (DIN 7991)

M x L	ØK	H	
M5 x 8	9.5	2.75	05.02357.00
M5 x 10	9.5	2.75	05.02358.00
M5 x 12	9.5	2.75	05.02359.00

M x L	ØK	H	
M5 x 16	9.5	2.75	05.02342.00
M5 x 20	9.5	2.75	05.02343.00
M5 x 25	9.5	2.75	05.02344.00
M6 x 12	10.5	3.3	05.02345.00
M6 x 16	10.5	3.3	05.01758.00
M6 x 20	10.5	3.3	05.02346.00
M6 x 25	10.5	3.3	05.02347.00
M6 x 30	10.5	3.3	05.02348.00
M8 x 14	14	4.4	05.02349.00
M8 x 16	14	4.4	05.02350.00
M8 x 20	14	4.4	05.02351.00
M8 x 25	14	4.4	05.02352.00
M8 x 30	14	4.4	05.02353.00
M8 x 40	14	4.4	05.02354.00
M8 x 60	14	4.4	05.02355.00
M8 x 80	14	4.4	05.02356.00

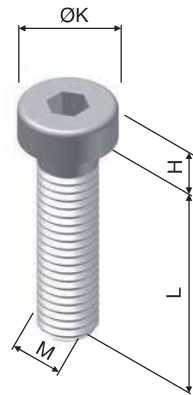

SW3 - M5  
SW4 - M6  
SW5 - M8

St, vz. - Festigkeitsklasse 8.8  
Steel, galvanized - Strength class 8.8  
Acier, galvanisé - Classification de résistance 8.8

#### DIN 7984

M x L	ØK	H	
M5 x 10	8.5	3.5	05.01494.00
M5 x 16	8.5	3.5	05.01495.00
M5 x 20	8.5	3.5	05.01496.00

M x L	ØK	H	
M5 x 25	8.5	3.5	05.01497.00
M6 x 40	10	4	05.01523.00
M8 x 16	13	5	05.01500.00
M8 x 20	13	5	05.01502.00
M8 x 25	13	5	05.01503.00
M8 x 30	13	5	05.01504.00
M8 x 40	13	5	05.01505.00
M8 x 50	13	5	05.01620.00
M8 x 55	13	5	05.01649.00
M8 x 60	13	5	05.01506.00
M8 x 80	13	5	05.01507.00
M12x 60	18	12	ISO 4762 05.01508.00
M12x 80	18	12	ISO 4762 05.01619.00
M12x110	18	12	ISO 4762 05.01509.00
M16x100	24	16	ISO 4762 05.01621.00

Technische Änderungen vorbehalten

# ISO-SCHRAUBEN

## ISO-SCREWS

### VIS-ISO

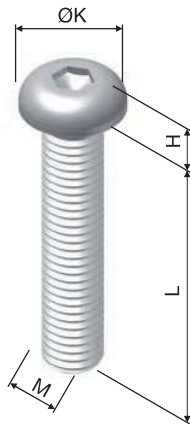

SW3 - M5  
SW4 - M6  
SW5 - M8

St, vz. - Festigkeitsklasse 10.9  
Steel, galvanized - Strength class 10.9  
Acier, galvanisé - Classification de résistance 10.9

#### ISO 7380

M x L	ØK	H	
M5 x 8	9.5	2.75	05.01400.00
M5 x 10	9.5	2.75	05.01401.00
M5 x 12	9.5	2.75	05.01402.00

M x L	ØK	H	
M5 x 16	9.5	2.75	05.01403.00
M5 x 20	9.5	2.75	05.01404.00
M5 x 25	9.5	2.75	05.01405.00
M6 x 12	10.5	3.3	05.01406.00
M6 x 16	10.5	3.3	05.01407.00
M6 x 20	10.5	3.3	05.01408.00
M6 x 25	10.5	3.3	05.01409.00
M6 x 30	10.5	3.3	05.01410.00
M8 x 14	14	4.4	05.01411.00
M8 x 16	14	4.4	05.01412.00
M8 x 20	14	4.4	05.01413.00
M8 x 25	14	4.4	05.01414.00
M8 x 30	14	4.4	05.01415.00
M8 x 40	14	4.4	05.01081.00
M8 x 60	14	4.4	05.01417.00
M8 x 80	14	4.4	05.01418.00

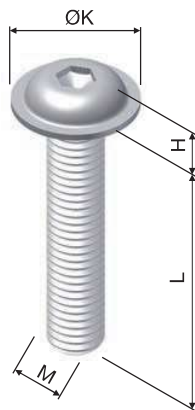

SW3 - M5  
SW4 - M6  
SW5 - M8

St, vz. - Festigkeitsklasse 10.9  
Steel, galvanized - Strength class 10.9  
Acier, galvanisé - Classification de résistance 10.9

#### ähnlich ISO 7380

M x L	ØK	H	
M5 x 8	11.1	2.7	05.01425.00
M5 x 10	11.1	2.7	05.01426.00
M5 x 12	11.1	2.7	05.01427.00

M x L	ØK	H	
M5 x 16	11.1	2.7	05.01428.00
M5 x 20	11.1	2.7	05.01429.00
M5 x 25	11.1	2.7	05.01430.00
M6 x 12	13.3	3.2	05.01431.00
M6 x 16	13.3	3.2	05.01432.00
M6 x 20	13.3	3.2	05.01433.00
M6 x 25	13.3	3.2	05.01434.00
M6 x 30	13.3	3.2	05.01435.00
M8 x 14	17.8	4.3	05.01436.00
M8 x 16	17.8	4.3	05.01437.00
M8 x 20	17.8	4.3	05.01438.00
M8 x 25	17.8	4.3	05.01439.00
M8 x 30	17.8	4.3	05.01082.00
M8 x 40	17.8	4.3	05.01441.00
M8 x 60	17.8	4.3	05.01442.00
M8 x 80	17.8	4.3	05.01443.00

3



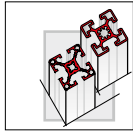

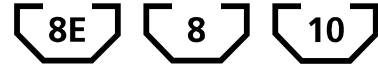

Technische Änderungen vorbehalten



# VERBINDERLASCHEN CONNECTING STRAP PLAQUES



**Erforderliche Verbinder:**  
**Connectors required:**  
**Fixations recommandées :**

- A** Hammerschraube M8x15  **05.01050.00**
- B** Hammerschraube M8x20  **05.01051.00**
- C** ISO 10642 M6x12  **05.02345.00**
- D** ISO 10642 M6x16  **05.01758.00**
- E** ISO 10642 M8x16  **05.02350.00**
- F** FM-Schraube SF8x25  **05.01124.00**

**30x60x6**

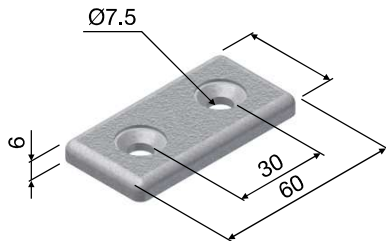

GD-Zn

**C D** **05.02073.00**

**40x80x6**

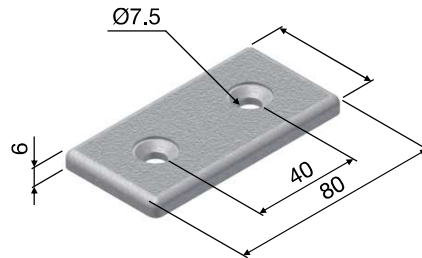

GD-Zn

**C D** **05.02033.00**

**SZ-Winkel 100x100x6**

Bracket 100x100x6 - Equerre 100x100x6

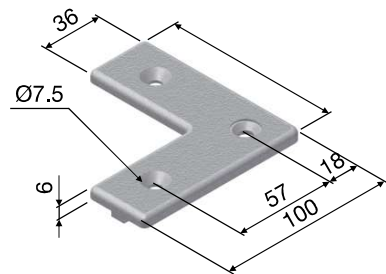

GD-Zn

mit Zentrierfahnen  
with centering lugs  
avec ergots de centrage **D B** **05.02032.00**

**45x90x6**

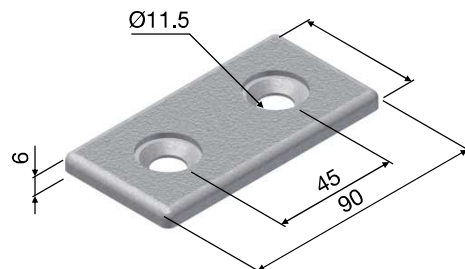

GD-Zn

**E B** **05.02074.00**

Technische Änderungen vorbehalten



# VERBINDERLASCHEN CONNECTING STRAP PLAQUES



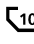

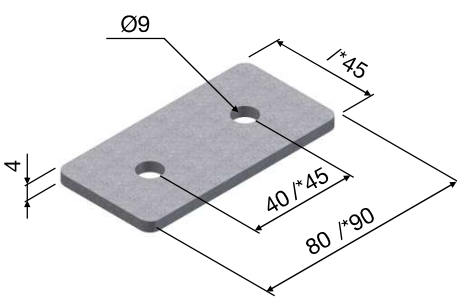
**40x80x4** **45x90x4**  

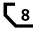

St, vz 4 mm

<b>40x80x4</b>	<b>B</b>	05.01570.00
<b>*45x90x4</b>	<b>B</b>	05.01571.00

**Knotenplatte 80, 90**    
Plate 80, 90 · Plaque de renfort 80, 90

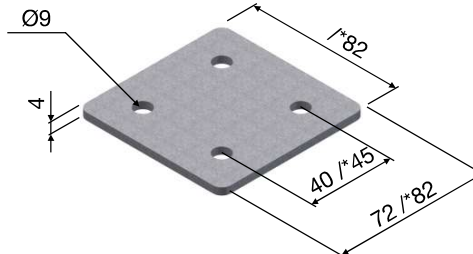

St, vz 4 mm

<b>80x80x4</b>	<b>B</b>	05.01568.00
<b>*90x90x4</b>	<b>B</b>	05.01569.00

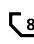
**Winkel 40**   
Bracket 40 · Equer  
DIN74 -

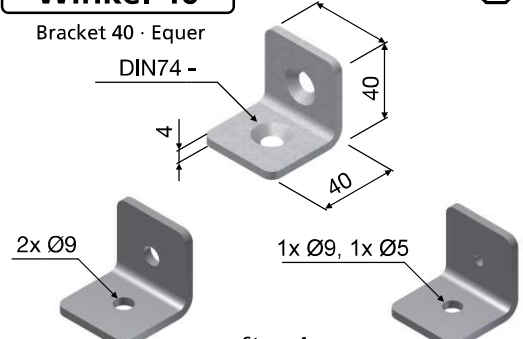

2x Ø9      1x Ø9, 1x Ø5

St, vz 4 mm

<b>E</b>	05.01572.00
----------	-------------

St, vz 4 mm      St, vz 4 mm

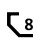
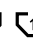

05.01809.00	<b>A</b>	<b>A</b>	05.01808.00
-------------	----------	----------	-------------

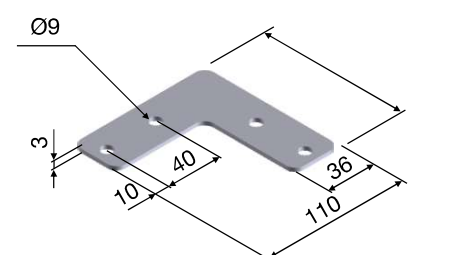
**Winkelplatte 90°**    
Plate angle 90° · Plaque de equer 90°



St, vz 3 mm

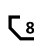

<b>B</b>	05.01160.00
----------	-------------

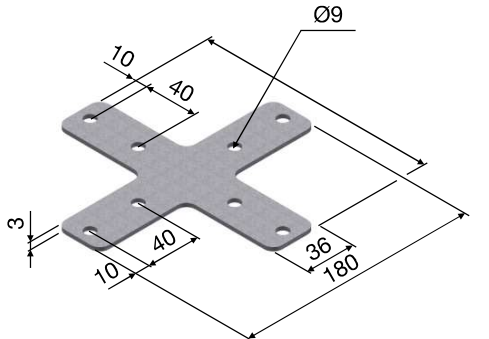
**Kreuzplatte**    
Cross plate · Croix-plaque



St, vz 3 mm

<b>B</b>	05.01162.00
----------	-------------

**T-Platte**    
T-plate · T-plaque

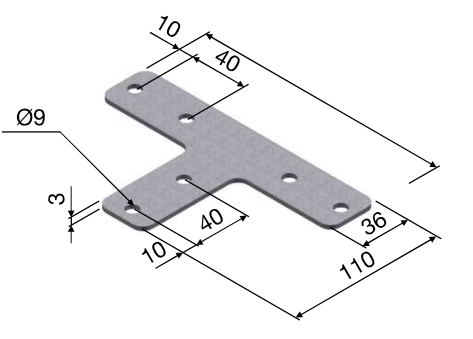

St, vz 3 mm

<b>B</b>	05.01161.00
----------	-------------



Technische Änderungen vorbehalten

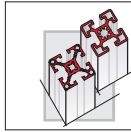

# HAMMERSCHRAUBE

## T-BOLT

### VIS DE TOUR

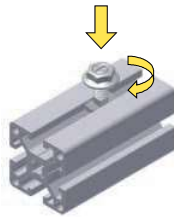

#### Innovative Vorteile

- Für nachträgliche Befestigungen in Alu-Profilen
- Für leichte bis mittlere Belastungen
- Leichte und schnelle Montage
- Kostengünstige Verbindung

#### Innovative advantages

- For later fastening to aluminium profiles
- For light to medium loads
- Quick and easy to fit
- Economic connector

#### Atouts novateurs

- Pour un montage ultérieur dans le profilé
- Pour charges légères et moyennes
- Montage aisé et rapide par 1/4 de tour
- Connexion bonne marché

#### Ausführung

Stahl, verzinkt  
Festigkeitsklasse 8.8

#### Design

Galvanized steel  
Strength class 8.8

#### Matière

Acier zingué  
Classe de résistance 8.8

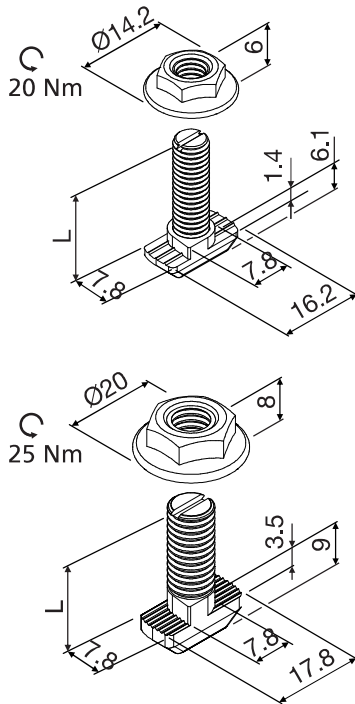

M6x16  
M6x20  
M6x25

St, vz

VA

05.02140.00

05.02141.00

05.02141.50

05.02142.00

05.02142.50

St, vz

VA



M8x15  
M8x20  
M8x25  
M8x30  
M8x40  
M8x50  
M8x60  
M8x80

05.01050.00

05.01051.00

05.01051.50 \*

05.01052.00

05.01052.50 \*

05.01053.00

05.01053.50 \*

05.01054.00

\*Nur für Nut 10

05.01055.00

05.01056.00

05.01057.00

Technische Änderungen vorbehalten



**Abdeckkappe für Flanschmutter M8 - PE**  
Cap for flange nut M8 - PE  
Cache pour écrou M8 - PE

05.01059.00

**Flanschmutter M6 - St, vz.**  
Flange nut M6 - steel, galvanized  
Ecrou M6 - acier, galvanisé

05.02237.00

**Flanschmutter M8 - St, vz.**  
Flange nut M8 - steel, galvanized  
Ecrou M8 - acier, galvanisé

05.02238.00

# HAMMERMUTTER

## T-NUT

### ECROUS 1/4 DE TOUR



#### Innovative Vorteile

- Universell einsetzbarer Verbinder
- Einlegbar an beliebiger Stelle in Profilvernut
- Geriffelte Oberfläche zum Durchbrechen der Eloxalschicht

#### Innovative advantages

- Connector for universal applications
- Can be inserted at any point in profile groove
- Ribbed surface to break through the anodized layer

#### Atouts novateurs

- Eléments de jonction universels
- Positionnables quel que soit l'emplacement dans la rainure
- Assemblage conducteur

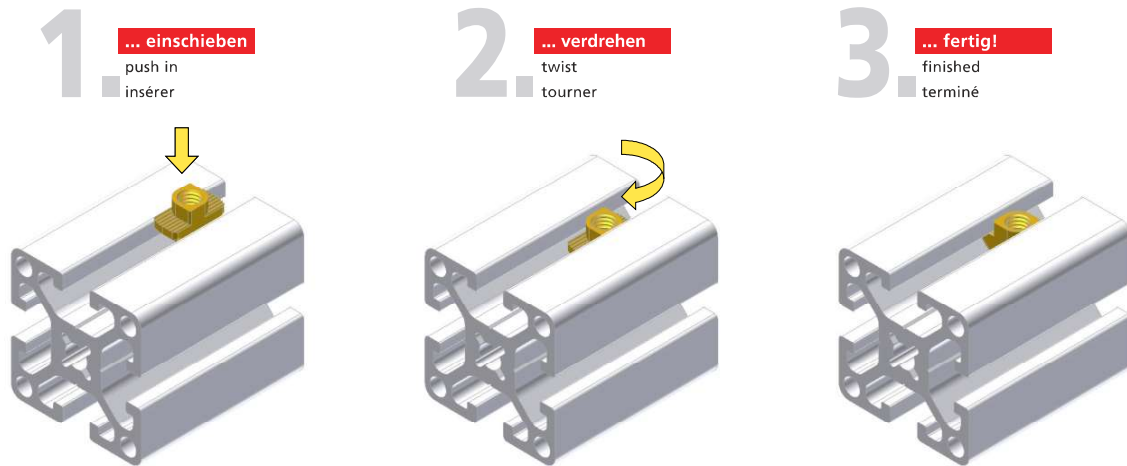

Code	Dimensions	Code	Size	Torque	St, vz	VA
8E		30	M4	4 Nm	05.01102.00	
8K			M5	6 Nm	05.01103.00	
	M6		10 Nm	05.01104.00	05.01104.50	

Code	Dimensions	Code	Size	Torque	St, vz	VA
8		40	M4	4 Nm	05.01660.00	
			M5	6 Nm	05.01661.00	
			M6	10 Nm	05.01662.00	

Code	Dimensions	Code	Size	Torque	St, vz	VA
10		45	M4	4 Nm	05.01138.00	
			M5	6 Nm	05.01105.00	
			M6	10 Nm	05.01106.00	05.01106.50
			M8	25 Nm	05.01107.00	05.01107.50

Technische Änderungen vorbehalten

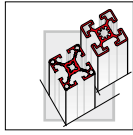

### Gewindeplättchen 5

- Für leichte Belastungen
- Stirnseitig in Profil einlegbar

**Ausführung: Stahl vergütet**  
M4 = blau verzinkt  
M5 = schwarz verzinkt

### Threaded plate 5

- For light loads
- Insertable in profile on front side

**Design: galvanized steel**  
M4 = blue galvanized  
M5 = black galvanized

### Ecrou plat 5

- Pour charges légères
- Insérable en bout de profilé

**Matière: Acier zingué**  
M4 = bleu zingué  
M5 = noir zingué

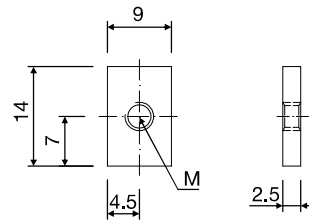
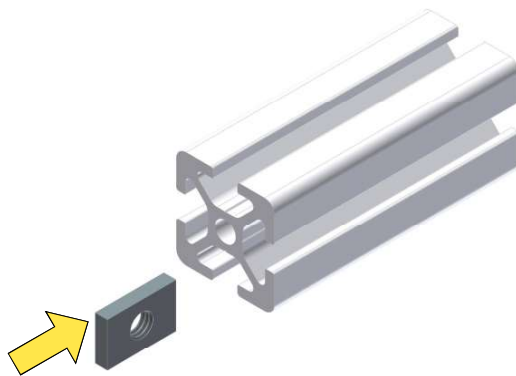

		St, vz.
	M4	3 Nm 05.01842.00
	M5	3 Nm 05.01843.00

### Einschiebemutter 5

- Für leichte Belastungen
- Stirnseitig in das Profil einlegbar

**Ausführung: Stahl vergütet**  
M4 = blau verzinkt  
M5 = schwarz verzinkt

### Insert nut 5

- For light loads
- Insertable in profile on front side

**Design: galvanized steel**  
M4 = blue galvanized  
M5 = black galvanized

### Ecrou demi-lune 5

- Pour charges légères
- Insérable en bout de profilé

**Matière: Acier zingué**  
M4 = bleu zingué  
M5 = noir zingué

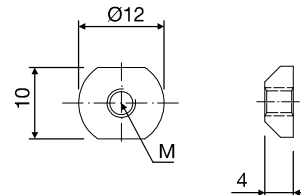
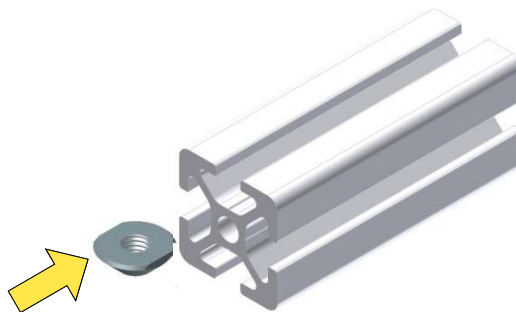

		St, vz.
	M4	3 Nm 05.01840.00
	M5	3 Nm 05.01841.00

**NUTENSTEIN 20, 30**  
**SLIDING BLOCK 20, 30**  
**COULISSEAU 20, 30**

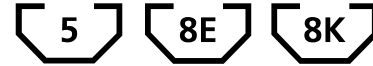

**Nutenstein halbrund**

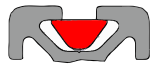
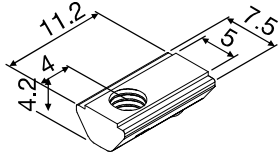

		St, vz	
5	M4	3 Nm	05.01655.00
	M5	4.5 Nm	05.01656.00

**Nutenstein halbrund**

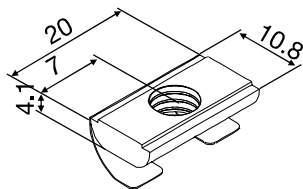

		St, vz	
8K	M4	3 Nm	05.02423.00
	M5	6 Nm	05.02424.00
	M6	12 Nm	05.02425.00
	M8	23 Nm	05.02426.00

**Nutenstein halbrund**

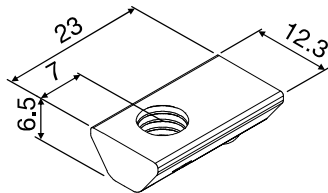

		St, vz	
8E	M5	6 Nm	05.01872.00
	M6	12 Nm	05.01871.00
	M8	23 Nm	05.01870.00

Nicht geeignet für Nut 8K

Not suitable for groove 8K

Ne convient pas pour la rainure 8K



**Nutenstein T-Form**

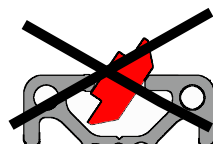
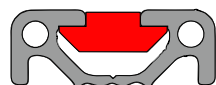
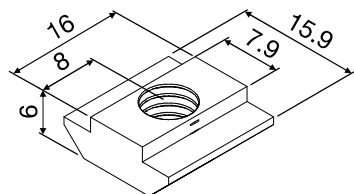

		St, vz	
8E	M4	4 Nm	05.01472.10
	M5	8 Nm	05.01471.10
	M6	10 Nm	05.01470.10
	M8	30 Nm	05.01469.10

Technische Änderungen vorbehalten



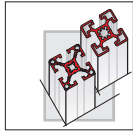

# NUTENSTEIN 40 SLIDING BLOCK 40 COULISSEAU 40



## Nutenstein halbrund

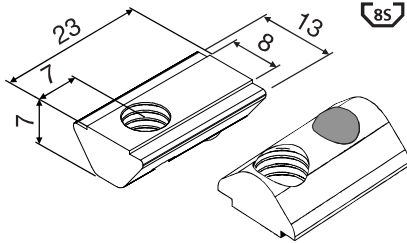

	St, vz	VA
M4	4 Nm 05.01063.00	
M5	8 Nm 05.01654.00	05.01654.50
M6	14 Nm 05.01653.00	05.01653.50
M8	25 Nm 05.01652.00	05.01652.50

Nur stirnseitig einsetzbar  
Insertable on front side  
Insérable en bout de profilé

## Nutenstein halbrund mit Gewindestift

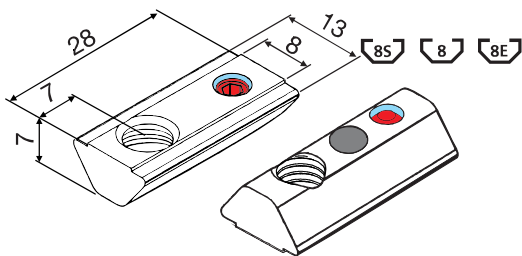

	St, vz
M5	8 Nm 05.02001.00
M6	14 Nm 05.02002.00
M8	25 Nm 05.02003.00

Nur stirnseitig einsetzbar  
Insertable on front side  
Insérable en bout de profilé

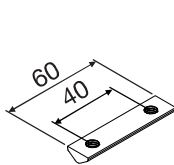

60 mm - M8

05.01093.00

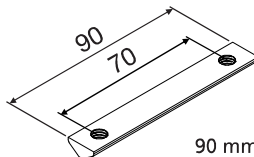

90 mm - M8

05.01094.00

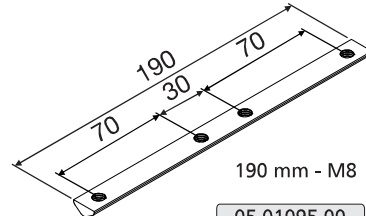

190 mm - M8

05.01095.00

## Nutenstein T-Form - schwer

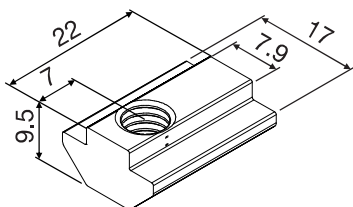

	St, vz	VA
M5	8 Nm 05.01087.00	
M6	14 Nm 05.01088.00	
M8	34 Nm 05.01089.00	05.01089.50



Technische Änderungen vorbehalten

# NUTENSTEIN 45

## SLIDING BLOCK 45

### COULISSEAU 45



#### Nutenstein halbrund

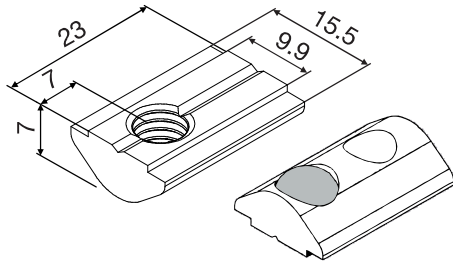

		St, vz	VA
	M5	10 Nm <a href="#">05.01066.00</a>	<a href="#">05.01066.50</a>
	M6	16 Nm <a href="#">05.01065.00</a>	<a href="#">05.01065.50</a>
	M8	28 Nm <a href="#">05.01064.00</a>	<a href="#">05.01064.50</a>

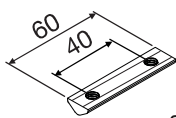
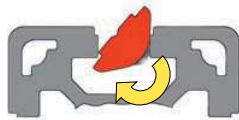
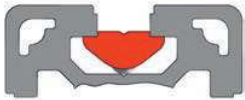

60mm - M8

[05.01096.00](#)

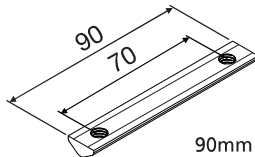

90mm - M8

[05.01097.00](#)

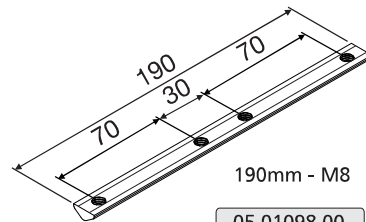

190mm - M8

[05.01098.00](#)

#### Nutenstein T-Form

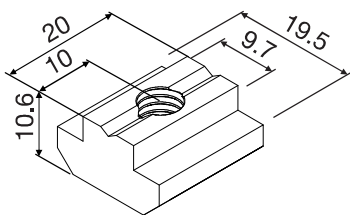

		St, vz	VA
	M5	12 Nm <a href="#">05.01069.00</a>	
	M6	21 Nm <a href="#">05.01068.00</a>	
	M8	42 Nm <a href="#">05.01067.00</a>	<a href="#">05.01067.50</a>
	Feder • Spring • Ressort		<a href="#">05.01080.00</a>

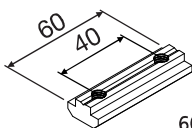
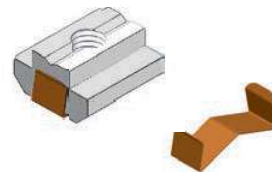

60 mm - M8

[05.01099.00](#)

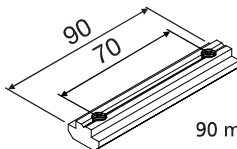

90 mm - M8

[05.01100.00](#)

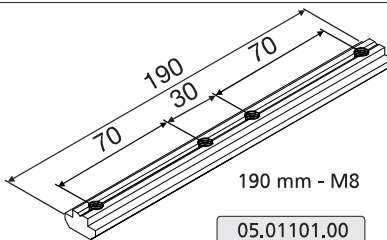

190 mm - M8

[05.01101.00](#)

Technische Änderungen vorbehalten

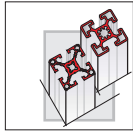

# VERBINDER CONNECTOR JONCTION



## Einschiebemutter

- Hoher Traganteil der Auflagefläche
- Durch Feder in der Nut fixiert
- Universelles Element für 3 Nut-Typen
- Stirnseitig in Profil einziehbar

**Ausführung**  
Stahl, verzinkt

## Insert nut

- High bearing section of resting surface
- Fastened in slot by spring
- Universal element for 3 slot versions
- Push into profile from front

**Design**  
Steel, galvanized

## Ecrou plat

- Grande surface d'appui
- Fixation par ressort dans la rainure
- Élément universel pour 3 types de rainures
- Insérable en bout de profilé

**Matière**  
Acier zingué

### Einschiebemutter

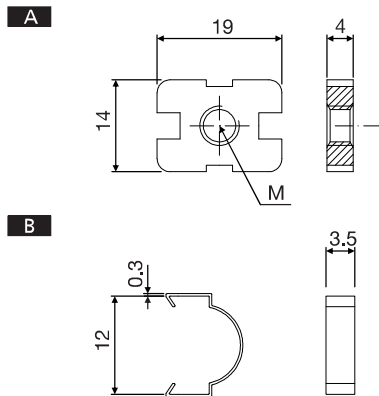

				A + B
8k	8E	8	10	
M4	3 Nm	05.01885.00		05.01885.10
M5	5 Nm	05.01886.00		05.01886.10
M6	10 Nm	05.01887.00		05.01887.10
M8	15 Nm	05.01888.00		05.01888.10
Feder • Spring • Ressort				05.01889.00

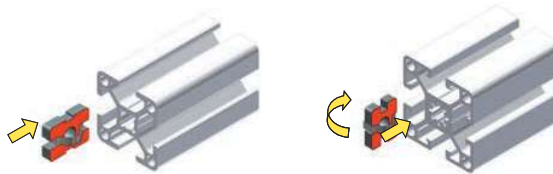

### Nutenstein flach

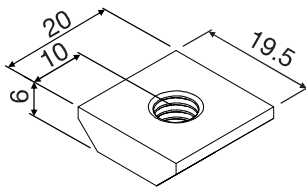

				St, vz
8	10	M4	5 Nm	05.01221.00
		M5	10 Nm	05.01072.00
		M6	14 Nm	05.01071.00
		M8	26 Nm	05.01070.00
Feder • Spring • Ressort				05.01080.00

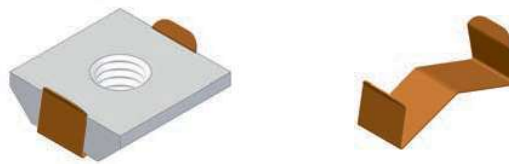
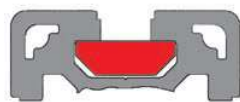

Technische Änderungen vorbehalten

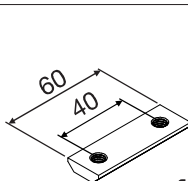

60 mm - M8

05.01090.00

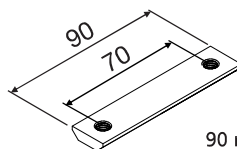

90 mm - M8

05.01091.00

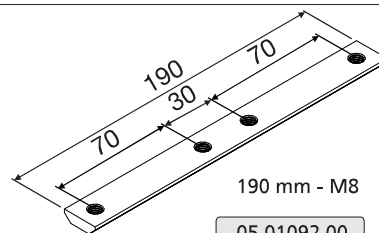

190 mm - M8

05.01092.00



# GEWINDE THREAD TARAUEE

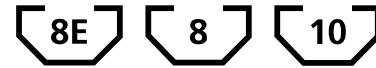

## Gewindehülse SF

- Für alle Profile mit 10 mm Kernloch
- Kein Gewindeschneiden
- Die selbstfurchende Gewindeform "FM-Spezial" erleichtert das Eindrehen
- Selbstzentrierend durch Zentrierschaft
- Einfache Montage durch Inbusschlüssel
- Innengewinde metrisch

## Threaded sleeve SF

- For all profiles with a central bore of 10 mm
- No thread cutting
- Self-tapping thread "FM-Spezial" makes it easier to screw in
- Self-centring with centring shaft
- Allen key for easy fitting
- Metric inner thread

## Douilles-insert autotaraudeuses centres

- Pour tous les profilés avec un trou central de 10 mm
- Taraudage superflu
- Vissage facile par vis autotaraudeuse à filetage spiralé "FM-Spezial" et enduction GleitMo
- Autocentrage par pion axial
- Montage aisé par clé 6 pans
- Taraudage métrique



Quer oder Stirnseitig einsetzbar

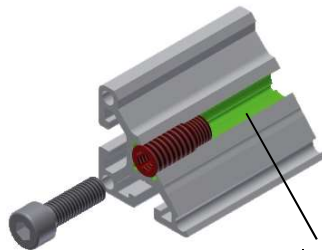

Kernloch Ø10

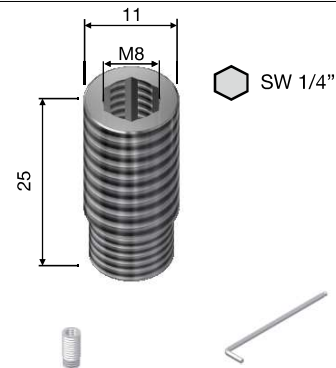

05.01369.00

05.01040.00

## Gewindeeinsätze

- Kein Gewindeschneiden
- Außengewinde metrisch
- Stahl, einsatzgehärtet, verzinkt

## Thread inserts

- No thread cutting
- Metric outer thread
- Steel, case hardened, galvanized

## Inserts taraudes

- Taraudage superflu
- Taraudage métrique
- Acier zingué

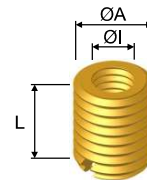
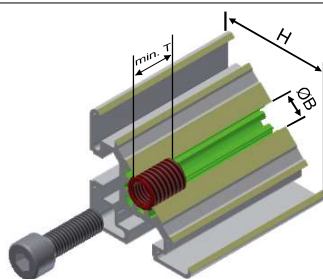

H	ØA	ØI	L	ØB	min. T		
30	8	M5	10	7.5	13	05.01370.00	05.01374.00
40	10	M6	14	9.2	17	05.01371.00	05.01375.00
40 45	12	M8	15	11.2	19	05.01372.00	05.01376.00
45	14	M10	18	13.2	22	05.01373.00	05.01377.00
45	16	M12	22	15.2	27	05.01398.00	05.01399.00

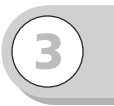

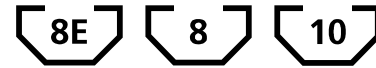
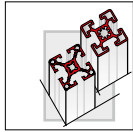

**Gewindehülse**

**Threaded sleeve**

**Douilles-insert canele**

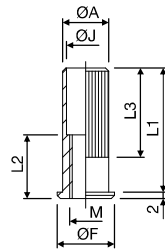
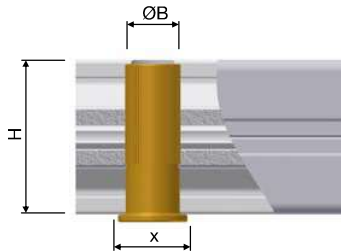

\* ohne Bund  
without collar  
sans epaulement

\*\*durchgehend  
continuous  
traversant

H	M	ØB	ØA	ØJ	ØF	L1	L2	L3	
30	M8	11	11.3	9	15	29	15	16	05.01421.00
40	M10	14	14.4	12	18	39	20	26	05.01422.00
40	M12	14	14.4	13	18	39	20	26	05.01423.00
45	M12	17	17.4	13	20	44	20	32	05.01424.00
45	M16	20	20.4	17	-*	54	32	-**	05.01420.00

**Verdrehsicherung**

**Non-twisting**

**Ecrou antirotation**

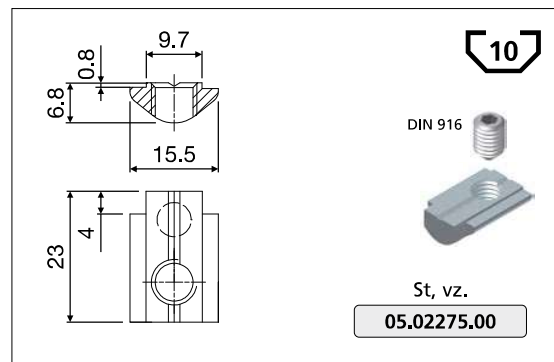
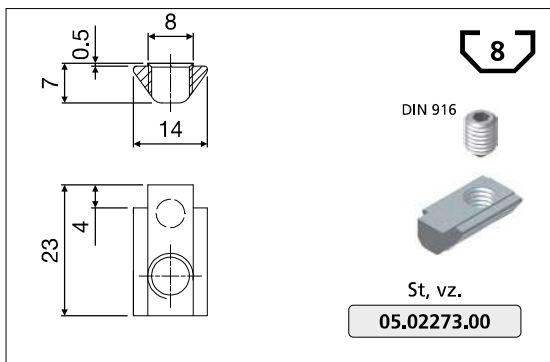
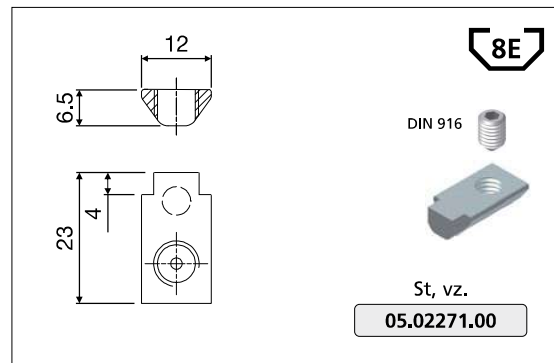
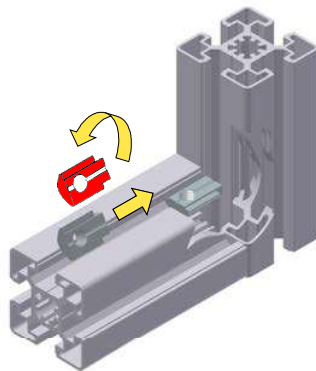

Technische Änderungen vorbehalten